

# Flo-Tite, Inc.

## Valves & Controls

### 3 PC TRUE BORE EXTENDED TUBE & CLAMP ENDS

## Multi-Choice Sanitary Design Ball Valve

For High Purity Applications

### Clamp End

Model 350



### Extended Tube End

Model 370



SIZE RANGE  
1/2" thru 6"

## DESIGN FEATURES

- Flo-Tite's Sanitary Ball Valves offer a high finish in both its standard surface of Ra 30-35 min. Optional finer Ra and Electropolish finish available thru 8-12 Ra.
- True Bore Port Design - eliminates pooling traces of media and improves flow characteristics for greater efficiency.
- Full body cavity fillers available to reduce the possibility of contamination by entrapment of process fluids in the void normally found behind the ball and the valve body in conventionally designed ball valves. Cavity fillers a major plus in applications where cross contamination is a concern.
- C.I.P. valves - clean-in-place.
- All ends incorporate a special boss for welding purge port.
- Extended tube ends are suitable for in-line Automatic Orbital Welding, without disassembly.

Same Proven Design as Our Industrial Valves,  
but designed specifically for the Sanitary Market

# DESIGN & TECHNICAL DATA

Flo-Tite 3 PC VALVES are designed for easy removal from the pipeline so that all valve components can be easily and quickly cleaned. All valve hardware is Stainless Steel Type 304 as standard

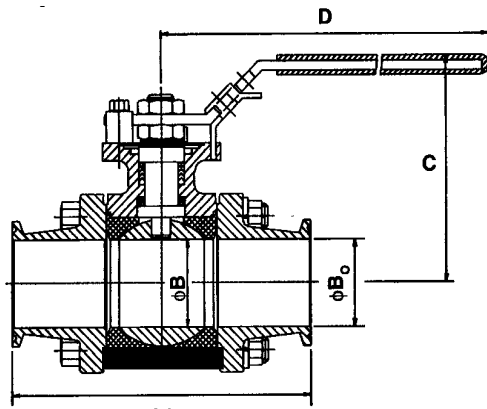

A1  
TRI-CLAMP END MODEL 350

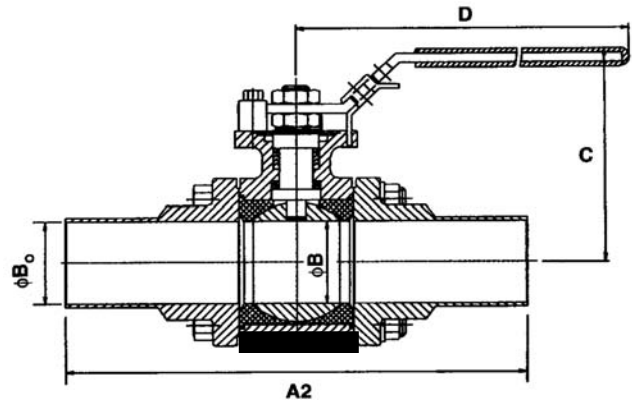

A2  
EXTENDED TUBE O.D. B/W END MODEL 370

## BILL OF MATERIALS (1/2" - 4"):

PART NAME	MATERIAL	QTY	PART NAME	MATERIAL	QTY
BODY	ASTM A351 Gr. CF3M (316L)	1	STEM PACKING	PTFE	1
END CAP	ASTM A351 Gr. CF3M (316L)	2	SLEEVE	SS304	1
BALL	ASTM A351 Gr. CF3M (316L)	1	Belleville Washer	SS301	2
Seat or Cavity Filler	PTFE	2	LOCK WASHER	SS304	1
STEM	ASTM A276 TYPE 316L	1	Valve Stop Set Sleeve	SS304	1
SPRING WASHER	SS304	4	VALVE STOP BOLT	SS304	1
			HANDLE	SS304	1
BODY BOLT	SS304/ASTM A193 Gr.B8#	8*	THIN NUT	SS304	2
THRUST BEARING	PTFE	1/1	PLASTIC COVER	PLASTIC	1
THRUST WASHER	PTFE	1	LOCATING LOCK	SS304	1

\*Qty will be 12 for 3" and 4"

## DIMENSIONS, TORQUES, AND WEIGHTS:

Size	A1	A2	Bore ØB	Port ØB	C	D	CV	WEIGHT lbs	BOLT TORQUE in-lbs	BREAK TORQUE (in-lbf)	
										with Cavity Filler	without Cavity Filler
1/2"	3.602	6.00	.0370	0.370	2.60	6.496	17	2	150	80	65
3/4"	4.114	6.00	0.620	0.620	2.60	6.496	38	3	150	110	80
1"	4.480	6.50	0.870	0.870	2.91	6.496	65	4	150	180	120
1-1/2"	5.055	7.50	1.370	1.370	3.62	7.874	180	7	280	295	215
2"	5.748	8.50	1.870	1.870	4.53	9.842	330	10	285	550	370
2-1/2"	6.850	10.0	2.559	2.070	5.04	9.646	430	20	330	1025	685
3"	7.402	11.5	2.992	2.870	6.42	15.354	675	32	600	1150	800
4"	8.758	12.5	4.016	3.834	7.09	15.354	1110	55	650	2600	1750

## TECHNICAL NOTES:

- Electropolish valves are solution cleaned and bagged as standard
- All materials of construction comply with FDA Requirements
- Material test reports available
- For additional technical information see Tech Bulletin page 45-05.

## AVAILABLE SURFACE FINISHES:

Grade	Ra (uin)	GRIT SIZE
A	8 - 12	320
B	15 - 20	240
C	20 - 25	180
D	30 - 35	150

This brochure is general in nature and manufacturer reserves the right to alter materials or to make design improvements.